

铝壳干式直流滤波电容器 DC-Link Capacitor (Dry-Type, Aluminum case)

■ 外形图 Outline Drawing

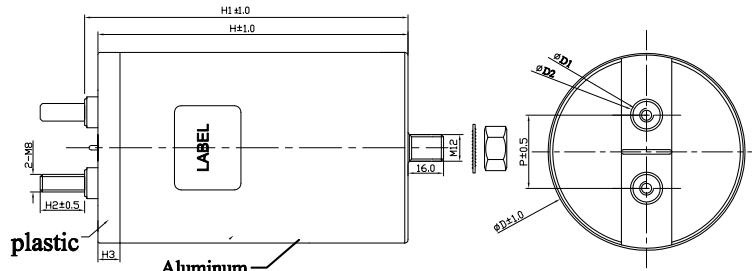

尺寸附加说明 Additional remark of dimensions

D=76mm	P=32mm; D1=12mm; D2=14mm; H3=10mm	
D=86mm	P=32mm; D1=12mm; D2=14mm; H3=10mm or 45mm	
	P=45mm;	Female terminals: D1=14mm; D2=16mm; H3=10mm or 45mm Male terminals: D1=16mm; D2=20mm; H3=10mm or 45mm
D=100mm	P=50mm; D1=14mm; D2=16mm;	H ≤ 100mm, H3=10mm
		H > 100mm, H3=45mm
D=116mm	P=50mm; D1=14mm; D2=16mm;	H ≤ 100mm, H3=10mm
		H > 100mm, H3=45mm
D=136mm	P=50mm; D1=14mm; D2=16mm; H3=45mm	
H3 can be changed in pursuance of customer's request. (H3=45mm when rated voltage > 1500Vdc)		

■ 特点

- 应用于直流滤波电路中，可替代电解电容
- 等效串联电阻小，能承受较大的纹波电流
- 自感小
- 有自愈性
- 寿命长
- 铝壳，树脂灌封

■ 应用场合

- 风能发电、太阳能发电用变频器上
- 交通工具，如：电动车和混合动力车
- 焊接设备，电梯，电机驱动

■ 技术要求 Specifications

引用标准 Reference Standard	GB/T 17702 (IEC 6107)	
气候类别 Climatic Category	D ≤ 116mm: 40/85/56 D = 136mm: 40/80/56	
工作温度范围 Operating Temperature Range	D ≤ 116mm: -40℃ ~ 85℃ (Θ _{hs} ≤ 85℃) D = 136mm: -40℃ ~ 80℃ (Θ _{hs} ≤ 80℃)	
贮存温度范围 Storage temperature range	-40℃ ~ 85℃	
电压范围 Voltage Range	600Vdc ~ 4 000Vdc	
容量范围 Capacitance Range	24μF ~ 5 600μF	
电容量允许偏差 Capacitance Tolerance	± 5%(J); ± 10%(K)	
耐电压 (两极之间) Test Voltage Between Terminals	1.5U _N (10s, 20℃ ± 5℃)	
耐电压 (极壳之间) Test Voltage Between Terminals And Case	U _N < 1 500Vdc, 3 000Vac(10s, 50Hz, 20℃ ± 5℃) U _N ≥ 1 500Vdc, (√2 U _N +1 000)Vac(10s, 50Hz, 20℃ ± 5℃)	
介质损耗角正切 tg δ _d	0.0002	
IR × C _N	≥ 5 000s (20℃ ,500Vdc,1min)	
过电压 Over Voltage	1.1U _N (30% of on-load-dur.)	
	1.15U _N (30min/day)	
	1.2U _N (5min/day)	
	1.3U _N (1min/day)	
	1.5U _N (30ms every time, 1 000times during the life of the capacitor)	
最高使用海拔 Max. Altitude	2 000m	
最大电极扭矩 Max. Torque of terminals	M6: 5Nm	M8:6Nm
最大安装扭矩 Max. Torque of Installation	10Nm	
安装 Installation	任意方向 Any Position	
预期寿命 Expected lifetime	100 000hrs @ U _N , Θ _{hs} =70℃	
失效率 Failure rate	50FIT	

■ Features

- Used in DC-Link circuits, Can replace electrolytic capacitor
- Low ESR, high ripple current handling capabilities
- Low Ls
- Self-healing property
- Long lifetime
- Aluminum case, Filled with resin

■ Applications

- Used in inverters of wind power and solar power
- Transportation: EV or HEV
- Welders, Elevators, Motor Driver systems

DC-Link Capacitor (Dry-Type, Aluminum case)

尺寸 Dimensions(mm)

U _N (Vdc)	C _N (μF)	ESR @1kHz (mΩ)	L _s (nH)	R _{th} (K/W)	Î (A)	I _{max} (A)			Dimension		
						40°C	50°C	60°C	ΦD	H	H1
600	480	1.5	45	5.6	1 560	70	65	55	76	95	101
	650	1.9	50	4.7	1 560	70	63	53	76	120	126
	780	2.2	55	4.6	1 550	67	59	50	76	140	146
	820	1.5	40	4.3	3 060	70	70	62	76	155	161
	950	1.5	45	4.2	3 090	70	70	63	76	174	180
	650	1.2	45	5.1	2 120	70	70	64	86	95	101
	880	1.5	50	4.7	2 110	70	70	60	86	120	126
	1000	1.8	55	4.6	2 070	70	65	55	86	136	142
	1100	1.7	55	4.6	2 180	70	67	57	86	140	146
	1100	1.4	40	4.4	4 110	70	70	64	86	155	161
	1300	1.4	45	4.3	4 230	70	70	64	86	174	180
	2000	1.1	55	3.0	6 510	70	70	70	86	252	258
	900	1.3	45	4.7	2 900	70	70	58	100	95	100
	1 200	1.4	50	4.1	2 850	70	70	58	100	120	125
	1 400	1.5	55	3.9	2 870	70	70	58	100	136	141
	1 500	1.6	55	3.8	2 740	70	70	58	100	140	145
	1 600	1.0	40	3.5	5 920	70	70	70	100	155	160
	1 800	1.0	45	3.2	5 800	70	70	70	100	174	179
	1 200	0.7	45	5.4	3 900	80	80	80	116	95	100
	1 600	1.0	50	5.0	3 830	80	80	70	116	120	125
2 000	1.1	55	4.9	3 960	80	80	67	116	140	145	
2 100	0.8	40	3.6	7 840	100	100	92	116	158	163	
2 400	0.9	45	3.4	7 810	100	100	90	116	174	179	
3 000	0.8	50	2.7	11 200	100	100	100	116	230	235	
5 600	0.8	60	2.0	15 940	100	100	100	136	295	300	
900	290	2.0	45	5.6	1 530	63	56	47	76	95	101
	400	2.6	50	4.7	1 560	61	54	45	76	120	126
	480	2.9	55	4.6	1 540	58	51	43	76	140	146
	480	1.7	40	4.3	2 910	70	69	58	76	155	161
	560	1.8	45	4.2	2 960	70	68	58	76	174	180
	380	1.6	45	5.1	2 010	70	65	55	86	95	101
	520	2.1	50	4.7	2 020	68	60	50	86	120	126
	580	2.2	55	4.6	1 950	67	59	50	86	136	142
	630	2.4	55	4.6	2 030	64	56	48	86	140	146
	650	1.5	40	4.4	3 940	70	70	62	86	155	161
	750	1.6	45	4.3	3 960	70	70	60	86	174	180
	1 100	1.3	55	3.0	5 810	70	70	70	86	252	258
	500	1.4	45	4.7	2 620	70	67	55	100	95	100
	700	1.6	50	4.1	2 700	70	67	55	100	120	125
	800	1.8	55	3.9	2 660	70	66	54	100	136	141
	850	1.8	55	3.8	2 700	70	66	54	100	140	145
	900	1.1	40	3.5	5 400	70	70	70	100	155	160
	1 000	1.1	45	3.2	5 230	70	70	70	100	174	179
	720	0.9	45	5.4	3 800	80	80	71	116	95	100
	980	1.2	50	5.0	3 810	80	76	64	116	120	125
	1 200	1.4	55	4.9	3 860	80	71	60	116	140	145
	1 200	0.9	40	3.6	7 280	100	100	87	116	158	163
	1 500	1.1	45	3.4	7 920	100	96	81	116	174	179
1 800	0.8	50	2.7	10 910	100	100	100	116	230	235	
3 200	0.8	60	2.0	14 780	100	100	100	136	295	300	

DC-Link Capacitor (Dry-Type, Aluminum case)

尺寸 Dimensions(mm)

U _N (Vdc)	C _N (μF)	ESR @1kHz (mΩ)	L _s (nH)	R _{th} (K/W)	Ĉ (A)	I _{max} (A)			Dimension		
						40°C	50°C	60°C	ΦD	H	H1
1 100	180	2.3	45	5.6	1 400	59	52	44	76	95	101
	250	3.0	50	4.7	1 430	56	50	42	76	120	126
	300	3.5	55	4.6	1 420	53	47	39	76	140	146
	310	1.9	40	4.3	2 770	70	65	55	76	155	161
	360	2.0	45	4.2	2 800	70	65	55	76	174	180
	240	1.9	45	5.1	1 870	68	60	51	86	95	101
	330	2.4	50	4.7	1 890	63	56	47	86	120	126
	420	2.3	55	4.6	2 080	65	58	49	86	136	142
	420	1.7	40	4.4	3 750	70	63	52	86	155	161
	500	1.8	45	4.3	3 730	70	67	57	86	174	180
	750	1.3	55	3.0	5 840	70	70	70	86	252	258
	350	1.5	45	4.7	2 640	70	65	53	100	95	100
	450	1.8	50	4.1	2 500	70	63	51	100	120	125
	520	2.0	55	3.9	2 500	70	62	50	100	136	141
	550	2.1	55	3.8	2 520	70	62	51	100	140	145
	580	1.1	40	3.5	5 020	70	70	70	100	155	160
	650	1.2	45	3.2	4 900	70	70	70	100	174	179
	450	1.0	45	5.4	3 500	80	80	68	116	95	100
	620	1.4	50	5.0	3 550	80	70	59	116	120	125
	750	1.6	55	4.9	3 550	75	66	56	116	140	145
780	0.9	40	3.6	6 960	100	100	85	116	158	163	
920	1.1	45	3.4	7 150	100	96	81	116	174	179	
1 200	0.9	50	2.7	10 710	100	100	100	116	230	235	
2 200	0.9	60	2.0	14 960	100	100	100	136	295	300	
1 500	90	3.3	45	5.6	1 220	49	44	37	76	95	101
	120	4.4	50	4.7	1 200	47	41	35	76	120	126
	150	4.9	55	4.6	1 230	45	39	33	76	140	146
	150	2.4	40	4.3	2 340	66	58	49	76	155	161
	170	2.5	45	4.2	2 310	65	58	49	76	174	180
	120	2.6	45	5.1	1 630	58	51	43	86	95	101
	170	3.3	50	4.7	1 690	54	48	40	86	120	126
	200	3.0	55	4.6	1 720	57	50	43	86	136	142
	210	2.0	40	4.4	3 280	70	63	53	86	155	161
	240	2.1	45	4.3	3 260	70	62	53	86	174	180
	380	1.5	55	3.0	5 080	70	70	70	86	252	258
	160	1.9	45	4.7	2 150	67	58	47	100	95	100
	210	2.3	50	4.1	2 080	65	56	46	100	120	125
	250	2.5	55	3.9	2 140	64	55	45	100	136	141
	280	1.3	40	3.5	4 320	70	70	67	100	155	160
	320	1.3	45	3.2	4 300	70	70	68	100	174	179
	230	1.4	45	5.4	3 120	77	68	57	116	95	100
	320	1.9	50	5.0	3 180	68	60	51	116	120	125
	390	2.1	55	4.9	3 200	66	58	49	116	140	145
	420	1.1	40	3.6	6 550	100	94	79	116	158	163
470	1.3	45	3.4	6 280	89	79	66	116	174	179	
600	1.0	50	2.7	9 200	100	89	75	116	230	235	
1 100	1.1	60	2.0	12 850	100	100	95	136	295	300	